

THE CITY OF NAPOLEON

BUILDING & ZONING DEPARTMENT

255 W. RIVERVIEW

(419)592-4010

Building Permit

Page 1 of 1

Permit Number: BP2005-40

Printed: 4/15/2005

Property Address: 25 Lemans Dr

Applicant Mr Builder LTD
Address: 970 Oakwood Ave

Approval Date:

Napoleon, OH 43545

Phone: 419-592-1806

Owners

Name: Mr. Art Shumaker
Address: 25 Lemans Dr

Phone: 419-

Contractors Mr Builder LTD
Address: 970 Oakwood Ave
Napoleon, OH 43545

Phone 419-592-1806

Fees and Receipts:

| Number | Description | Amount |
|-------------|----------------------|--------|
| FEE2005-306 | Windows/Doors (Auto) | \$6.00 |

Total Fees: \$6.00

Description

Structure Use:

Start Date:

Construction Value:

End Date:

Floor Areas

Living Space:

Other:

Basement/Storage:

Total Area:

Garage:

Description of work to be done: Putting bay window

Applicant signature: 

Date: 04-15-05

F

Inspection Record

Inspection #: INSP2005-84

Page: 1

Printed: 4/29/2005

Address: 25 Lemans Dr
Napoleon, OH 43545

Reference #: BP2005-40

Applicant: Mr. Art Shumaker

Directions To Parcel:

Inspection Type: Building Final

Date: 4/15/2005

Inspector: Tom

Status: Closed

Passed?

Required Steps:

Comments: oked new bay window

Inspection Checklist:

-
-
-
-
-
-
-
-
-

-
-
-
-
-
-
-
-

Corrections:

Correction Code:

Date:

Correction Description:

Status:

Correction Made Date:

Conditions:

Condition Code:

Description:

Date:

Department:

Status:

Other Fields:

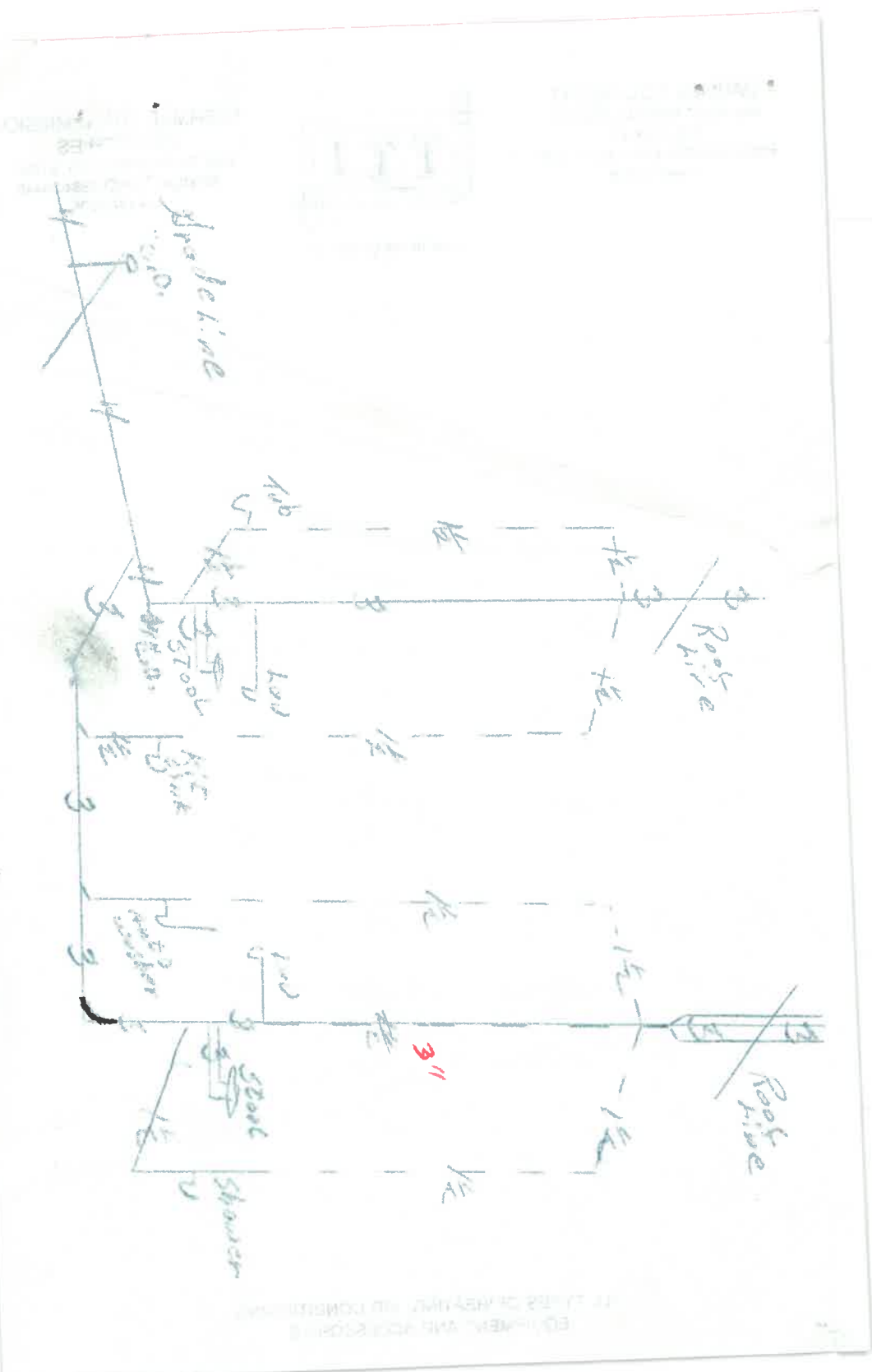

MAUMZE EQUIPMENT
500 WEST INDIANA AVENUE
P.O. BOX 67
PERRYSBURG, OHIO 43551-1531
419-874-7968

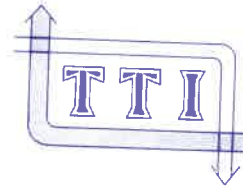

"HOME OF THE EFFICIENTS"

**THERMAL TRANSMISSION
INDUSTRIES**
1205 EAST SANDUSKY STREET
FINDLAY, OHIO 45840-6446
419-422-3805

ALL TYPES OF HEATING, AIR CONDITIONING
EQUIPMENT AND ACCESSORIES

CITY OF NAPOLEON GENERAL PERMIT APPLICATION

THIS APPLICATION IS FOR RESIDENTIAL CONSTRUCTION INCLUDING BUILDING, ELECTRICAL, PLUMBING, MECHANICAL, DEMOLITIONS, REMODELING.

DATE: _____ JOB LOCATION: _____

OWNER: ART SHUMAKER PHONE: _____

OWNER ADDRESS: 25 CAMANS CITY: NAP. ZIP: OH.

CONTRACTOR: MR. BUILDER LTD PHONE: 419 592-1806

CONTRACTOR LICENSED WITH THE CITY OF NAPOLEON?: YES: X NO: _____

DESCRIPTION OF WORK TO BE PERFORMED: Remove small window & install BAY WINDOW

PLEASE MARK THE TYPE OF WORK YOU WILL BE PERFORMING

- | | |
|---|--|
| <input type="checkbox"/> A/C ADD ON | <input type="checkbox"/> REMODELING |
| <input type="checkbox"/> BOILER REPLACEMENT | <input type="checkbox"/> ROOFING |
| <input type="checkbox"/> CURBING | <input type="checkbox"/> SEWER REPAIRS** |
| <input type="checkbox"/> DECKS * | <input type="checkbox"/> SIDEWALK* |
| <input type="checkbox"/> DRIVEWAY* | <input type="checkbox"/> SIDING |
| <input type="checkbox"/> ELECTRICAL SERVICE UPGRADE | <input type="checkbox"/> STORAGE SHED* |
| <input type="checkbox"/> ELECTRICAL SERVICE NEW | <input type="checkbox"/> SWIMMING POOL* |
| <input type="checkbox"/> FENCE* | <input type="checkbox"/> FURNACE REPLACEMENT |
| <input type="checkbox"/> ADDITIONS* | <input type="checkbox"/> TEMP ELECTRIC |
| <input type="checkbox"/> FURNACE NEW | <input type="checkbox"/> WATER TAP (size _____") |
| <input type="checkbox"/> LAWN METER | <input type="checkbox"/> WINDOWS |
| <input type="checkbox"/> PLUMBING | <input type="checkbox"/> ZONING |

***PLEASE INCLUDE A PICTURE SHOWING MEASUREMENTS FROM EXISTING STRUCTURES AND PROPERTY LINES. INDICATING THE TYPE OF WORK YOU WISH TO PERFORM.**

**** IF WORK REQUIRES GOING INTO THE STREET A STREET BOND IS REQUIRED!**

FOR PERMIT COSTS PLEASE FILL OUT REVERSE SIDE.

PERMIT COST WORKSHEET

| JOB | BASE FEE | TOTAL |
|--|-----------|--------------------|
| SIDING TOTAL SQ _____ X 1.00 + | \$5.00 = | \$ _____ |
| ROOFING TOTAL SQ _____ X 1.00 + | \$5.00 = | \$ _____ |
| WINDOWS # OF WINDOWS <u> 1 </u> X 1.00 + | \$5.00 = | \$ <u> 6.00 </u> |
| ELECTRICAL # OF CIRCUITS _____ X 3.00 + | \$15.00 = | \$ _____ |
| ELECTRICAL SERVICE UPGRADE | \$15.00 = | \$ _____ |
| PLUMBING (INSIDE) | \$10.00 = | \$ _____ |
| PLUMBING/SEWER (OUTSIDE) | \$25.00 = | \$ _____ |
| WATER HEATER | \$5.00 | \$ _____ |
| SHED UNDER 200 SQ FT | \$ 5.00 | \$ _____ |
| FURNACE OR A/C (REPLACEMENT) | \$ 5.00 | \$ _____ |
| DEMOLITION | \$30.00 | \$ _____ |
| SIDEWALK REPLACEMENT/ NEW | \$25.00 | \$ _____ |

ALL OTHER CONSTRUCTION, ALTERATIONS, REMODELING, SHEDS, DECKS & FENCES NOT LISTED ABOVE IS BASED ON COST OF WORK BEING PERFORMED.

COST OF WORK \$ _____ (SEE CHART) \$ _____

| | | | |
|-----------|---|-----------|-------|
| 0.00 | - | 250.00 | 0.00 |
| 250.00 | - | 1,000.00 | 10.00 |
| 1,000.00 | - | 1,999.00 | 12.00 |
| 2,000.00 | - | 2,999.00 | 14.00 |
| 3,000.00 | - | 3,999.00 | 16.00 |
| 4,000.00 | - | 4,999.00 | 18.00 |
| 5,000.00 | - | 5,999.00 | 19.00 |
| 6,000.00 | - | 6,999.00 | 20.00 |
| 7,000.00 | - | 7,999.00 | 21.00 |
| 8,000.00 | - | 8,999.00 | 22.00 |
| 9,000.00 | - | 9,999.00 | 23.00 |
| 10,000.00 | - | 10,999.00 | 24.00 |

| | | | |
|-----------|---|-----------|-------|
| 11,000.00 | - | 11,999.00 | 25.00 |
| 12,000.00 | - | 12,999.00 | 26.00 |
| 13,000.00 | - | 13,999.00 | 27.00 |
| 14,000.00 | - | 14,999.00 | 28.00 |
| 15,000.00 | - | 15,999.00 | 29.00 |
| 16,000.00 | - | 16,999.00 | 30.00 |
| 17,000.00 | - | 17,999.00 | 31.00 |
| 18,000.00 | - | 18,999.00 | 32.00 |
| 19,000.00 | - | 19,999.00 | 33.00 |
| 20,000.00 | - | 20,999.00 | 34.00 |
| 21,000.00 | - | 21,999.00 | 35.00 |
| 22,000.00 | - | 22,999.00 | 36.00 |

THE CITY OF NAPOLEON

BUILDING & ZONING DEPARTMENT

255 W. RIVERVIEW

(419)592-4010

Building Permit

Page 1 of 1

Permit Number: BP2005-40

Printed: 4/15/2005

Property Address: 25 Lemans Dr

Applicant Mr Builder LTD
Address: 970 Oakwood Ave

Approval Date:

Napoleon, OH 43545

Phone: 419-592-1806

Owners

Name: Mr. Art Shumaker
Address: 25 Lemans Dr

Phone: 419-

Contractors Mr Builder LTD
Address: 970 Oakwood Ave
Napoleon, OH 43545

Phone 419-592-1806

Fees and Receipts:

| Number | Description | Amount |
|--------------------|----------------------|---------------|
| FEE2005-306 | Windows/Doors (Auto) | \$6.00 |
| Total Fees: | | \$6.00 |

Description

Structure Use:

Start Date:

Construction Value:

End Date:

Floor Areas

Living Space:

Other:

Basement/Storage:

Total Area:

Garage:

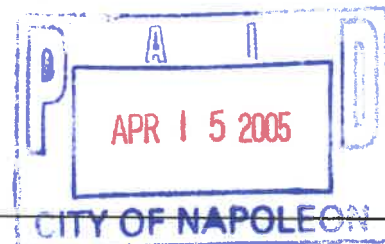

Description of work to be done: Putting bay window

Applicant signature: Mark Kelle

Date: 04-15-05

1800
MAY 1 2 2003
NEW YORK